



Spruhan Engineering, P.C.

80 JEWETT ST, (SUITE 1)
NEWTON, MA 02458

Tel: 617-816-0722
Email: edmond@spruhaneng.com

122-124
CABOT STREET
NEWTON
MASSACHUSETTS

SITE PLAN

REVISION BLOCK

Table with 3 columns: BY, DESCRIPTION, DATE. The table is currently empty.

All legal rights including, but not limited to, copyright and design patent rights, in the designs, arrangements and plans shown on this document are the property of Spruhan Engineering, P.C. They may not be used or reused in whole or in part, except in connection with this project, without the prior written consent of Spruhan Engineering, P.C. Written dimensions on these drawings shall have precedence over scaled dimensions. Contractors shall verify and be responsible for all dimensions and conditions on this project, and Spruhan Engineering, P.C. must be notified of any variation from the dimensions and conditions shown by these drawings.



4/25/25

DATE: 4/25/25
DRAWN BY: H.M.S.
CHECKED BY: E.S.
APPROVED BY: E.S.

CIVIL PLAN II
FILLS, CUTS, AND SITE
PREPARATION PLAN

SHEET 3 OF 6

TABLE 1 - FLOODPLAIN IMPACT & MITIGATION SUMMARY

ELEVATION (FT)	FILL		CUT	
	IMPACT (CF)	MITIGATION (CF)	-A-	B-A
77-78	64	1402	-	1338
78-79	200	1411	-	1210
79-79.03	5	19	-	14
TOTALS	269	2832	-	2563

FILL IMPACT -A-: SUM OF FILLS FROM TABLE 2 FOR EACH AFFECTED 1-FOOT ELEVATION
CUT MITIGATION -B-: SUM OF CUTS FROM TABLE 3 FOR EACH AFFECTED 1-FOOT ELEVATION

TABLE 2 - FILLS

PROPOSED IMPROVEMENTS				
ELEVATION (FT)	FILL AREA (SF)	HEIGHT (FT)	FILL VOLUME (CF)	COMMENT
77-78	55	1	55	LANDING & PIERS, STEPS
78-79	143	1	143	LANDING & PIERS, STEPS, DRIVEWAY
79-79.03	120	0.03	4	LANDING & PIERS, STEPS, DRIVEWAY
TOTAL			202	
NEW PIERS				
77-78	9	1	9	(06) 14"x14" PIERS
78-79	19	1	19	(13) 14"x14" PIERS
79-79.03	19	0.03	1	(13) 14"x14" PIERS
TOTAL			28	
PROPOSED GRADING				
77-78	0	1	0	-
78-79	39	1	39	-
79-79.03	41	0.03	1	-
TOTAL			40	-

TABLE 3 - CUTS

EXISTING BUILDING				
ELEVATION (FT)	CUT AREA (SF)	HEIGHT (FT)	CUT VOLUME (CF)	COMMENT
77-78	1402	1	1402	EX. BUILDING, DRIVEWAY
78-79	1411	1	1411	EX. BUILDING, DRIVEWAY, WALKWAY
79-79.03	637	0.03	19	EX. BUILDING, DRIVEWAY, WALKWAY
TOTAL			2832	
PROPOSED GRADING				
77-78	0	1	0	-
78-79	0	1	0	-
79-79.03	0	0.03	0	-
TOTAL			0	-

LEGEND

- BOUND
- BOLLARD
- TREE
- SEWER MANHOLE
- DRAIN MANHOLE
- CATCH BASIN
- WATER MANHOLE
- WATER VALVE
- GAS VALVE
- UTILITY POLE
- MANHOLE
- SPOT GRADE
- FENCE
- SEWER LINE
- WATER LINE
- GAS LINE
- UNDERGROUND ELECTRIC LINE
- CONTOUR LINE (MJR)
- CONTOUR LINE (MNR)
- PROP CONTOUR LINE
- EXISTING FLOODPLAIN CONTOUR LINE
- PROPOSED FLOODPLAIN CONTOUR LINE
- PROPOSED DOWNSPOUT
- TEST PIT #X
- INSPECTION CLEAOUTS
- SUMP PUMP
- FIRST FLOOR ELEV.
- TOP OF FOUNDATION ELEV.
- GARAGE FLOOR ELEV.
- BASEMENT FLOOR ELEV.
- OVERHANG
- 4-FOOT TALL ORANGE FENCE WITH TREE PROTECTION SIGNS
- 12" COMPOST SOCK ONLY

WORK ON THE SITE IS SUBJECT TO TREE PERMIT TR-24-98 DATED JULY 9, 2024 AND THE TREE PROTECTION PLAN PREPARED BY SIRIUS LANDSCAPES, INC. SUBMITTED AS PART OF TREE PERMIT APPLICATION.

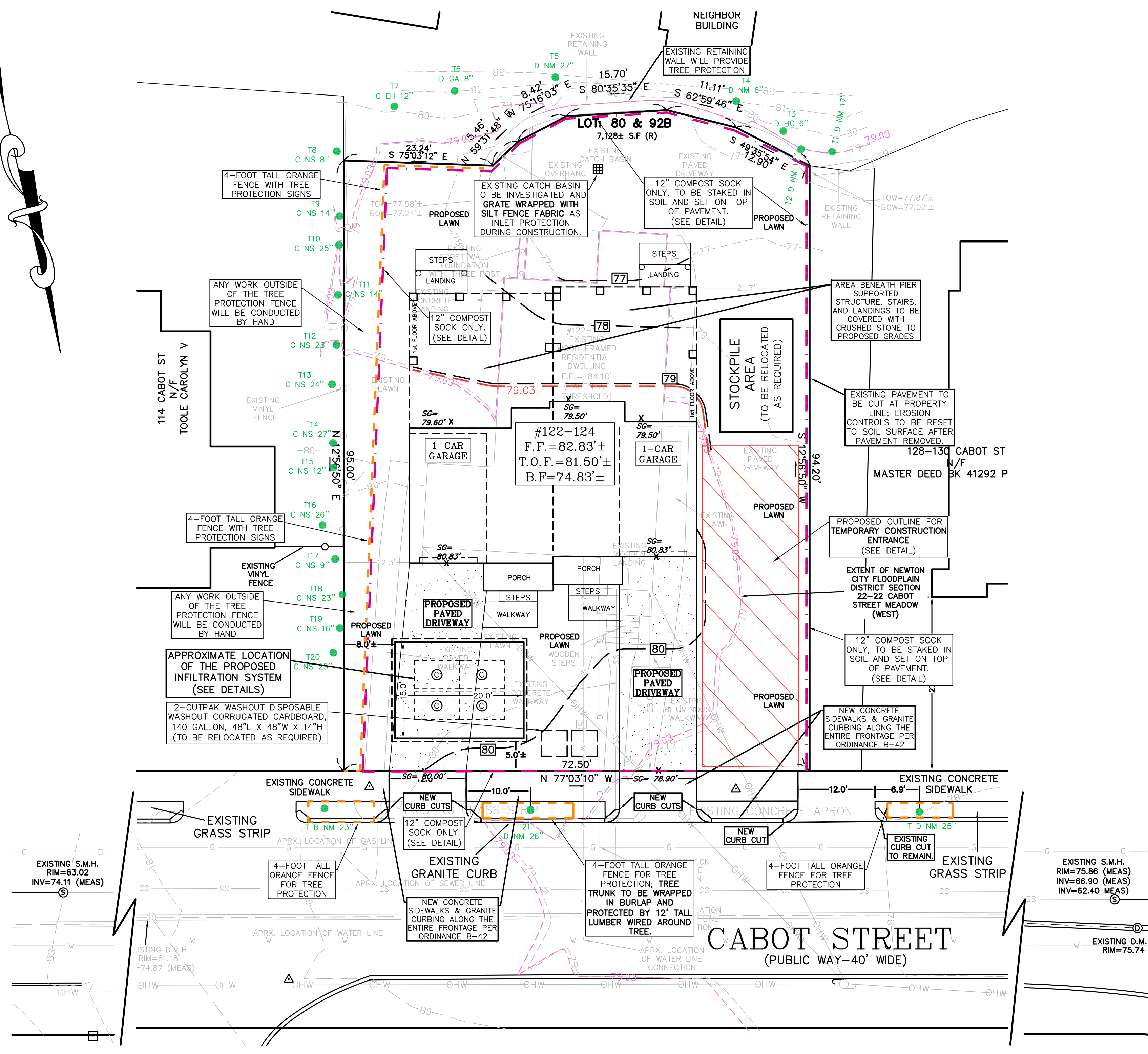
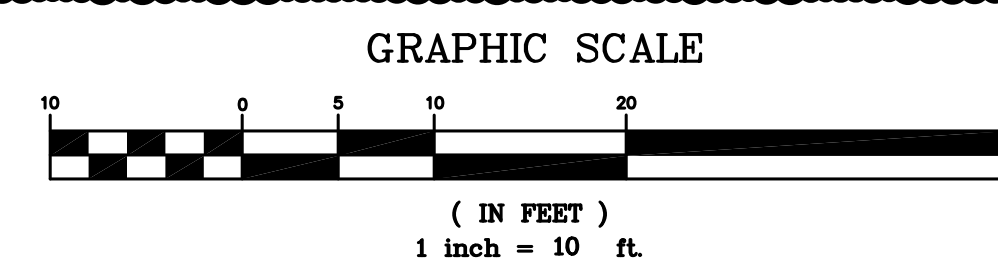



Spruhan Engineering, P.C.

80 JEWETT ST, (SUITE 1)

NEWTON, MA 02458

Tel: 617-816-0722

Email: edmond@spruhaneng.com

122-124 CABOT STREET NEWTON MASSACHUSETTS

SITE PLAN

REVISION BLOCK

Table with 3 columns: BY, DESCRIPTION, DATE

All legal rights including, but not limited to, copyright and design patent rights, in the designs, arrangements and plans shown on this document are the property of Spruhan Engineering, P.C.



4/25/25

DATE: 4/25/25
DRAWN BY: H.M.S.
CHECKED BY: E.S.
APPROVED BY: E.S.

CIVIL PLAN III DRAINAGE & UTILITIES

SHEET 4 OF 6

DEEP OBSERVATION HOLE LOG TP-1. Table with columns: Depth (ft), Horizon/ Layer, Matrix: Color-Moist, Redoximorphic Features, Texture (USDA), Coarse Fragments (Percent by Volume), Structure, Consistence (Moist), Other.

DEEP OBSERVATION HOLE LOG TP-2. Table with columns: Depth (ft), Horizon/ Layer, Matrix: Color-Moist, Redoximorphic Features, Texture (USDA), Coarse Fragments (Percent by Volume), Structure, Consistence (Moist), Other.

PHOSPHORUS LOAD TABLE. Table with columns: Existing load, Proposed load, BMP load (Reduction), Phosphorus reduction, Total impervious area, Total infiltrated/treated area, Total Available BMP Storage.

THE INFILTRATION SYSTEM IS DESIGNED FOR ALL IMPERVIOUS AREAS, HOWEVER ONLY 0.0634 ACRES WILL BE INFILTRATED/TREATED, AND THIS CAPTURED AREA IS USED IN PHOSPHORUS LOAD CALCULATIONS.

PHOSPHORUS LOAD TABLE

NOTES:

- 1. SPRUHAN ENGINEERING, P.C. ACCEPTS NO LIABILITY FOR GROUND WATER OR OTHER SURFACE WATER IN BASEMENT.
2. THE CONTRACTOR IS RESPONSIBLE FOR NOTIFYING THE DESIGN ENGINEER FOR INSPECTIONS OR AS-BUILT LOCATIONS.
3. CONTRACTOR TO ENSURE ALL RAIN WATER FROM SPLASH BLOCKS (IF ANY) IS DIVERTED AWAY FROM BUILDING FOUNDATION AND DIVERTED AWAY FROM NEIGHBORING PROPERTIES.
4. IF THE CURB-CUT IS PROPOSED WITHIN THE CITY STREET TREE BUFFER ZONE OF (8) FEET, THEN APPROVAL FROM THE CITY OF NEWTON SUPERINTENDENT OF URBAN FORESTRY WILL BE REQUIRED.
5. CONTRACTOR TO REGULARLY INSPECT AND MAINTAIN THE EROSION AND SEDIMENT CONTROLS MEASURES.
6. ANY TREE BEING REMOVED SHALL COMPLY WITH CITY OF NEWTON TREE ORDINANCE.
7. WHEN AN OPEN EXCAVATION IS MADE WHICH REQUIRES A VERTICAL CUT OF SOIL, THAT VERTICAL CUT MUST BE SUPPORTED.
8. SEWER/RAIN PIPES MUST BE ENCASED IN CONCRETE WHERE GROUND COVER IS LESS THAN 3 FT.
9. IF WATER AND SEWER LINES MUST CROSS OR ARE WITHIN 10- FEET HORIZONTALLY, THE SEWER PIPE AND WATER PIPE MUST BE ENCASED, THIS REQUIREMENT STANDS UNLESS THE WATER IS A MINIMUM OF 18-INCHES ABOVE THE SEWER PIPE OR IF THERE IS A MINIMUM OF A 10-FOOT HORIZONTAL SEPARATION.

LEGEND

- BOUND
BOLLARD
TREE
SEWER MANHOLE
DRAIN MANHOLE
CATCH BASIN
WATER MANHOLE
WATER VALVE
GAS VALVE
UTILITY POLE
MANHOLE
SPOT GRADE
FENCE
SEWER LINE
WATER LINE
GAS LINE
UNDERGROUND ELECTRIC LINE
CONTOUR LINE (MJR)
CONTOUR LINE (MNR)
PROP CONTOUR LINE
EXISTING FLOODPLAIN CONTOUR LINE
PROPOSED FLOODPLAIN CONTOUR LINE
PROPOSED DOWNSPOUT
TEST PIT #X
INSPECTION CLEAOUTS
SUMP PUMP
FIRST FLOOR ELEV.
TOP OF FOUNDATION ELEV.
GARAGE FLOOR ELEV.
BASEMENT FLOOR ELEV.
OVERHANG
4-FOOT TALL ORANGE FENCE WITH TREE PROTECTION SIGNS
12" COMPOST SOCK ONLY

WORK ON THE SITE IS SUBJECT TO TREE PERMIT TR-24-98 DATED JULY 9, 2024 AND THE TREE PROTECTION PLAN PREPARED BY SIRIUS LANDSCAPES, INC. SUBMITTED AS PART OF TREE PERMIT APPLICATION.

NOTE: 1. IF WATER AND SEWER LINES MUST CROSS OR ARE WITHIN 10- FEET HORIZONTALLY, THE SEWER PIPE AND WATER PIPE MUST BE ENCASED. THIS REQUIREMENT STANDS UNLESS THE WATER IS A MINIMUM OF 18-INCHES ABOVE THE SEWER PIPE OR IF THERE IS A MINIMUM OF A 10-FOOT HORIZONTAL SEPARATION.
2. SEWER/RAIN PIPES MUST BE ENCASED IN CONCRETE WHERE GROUND COVER IS LESS THAN 3 FT.

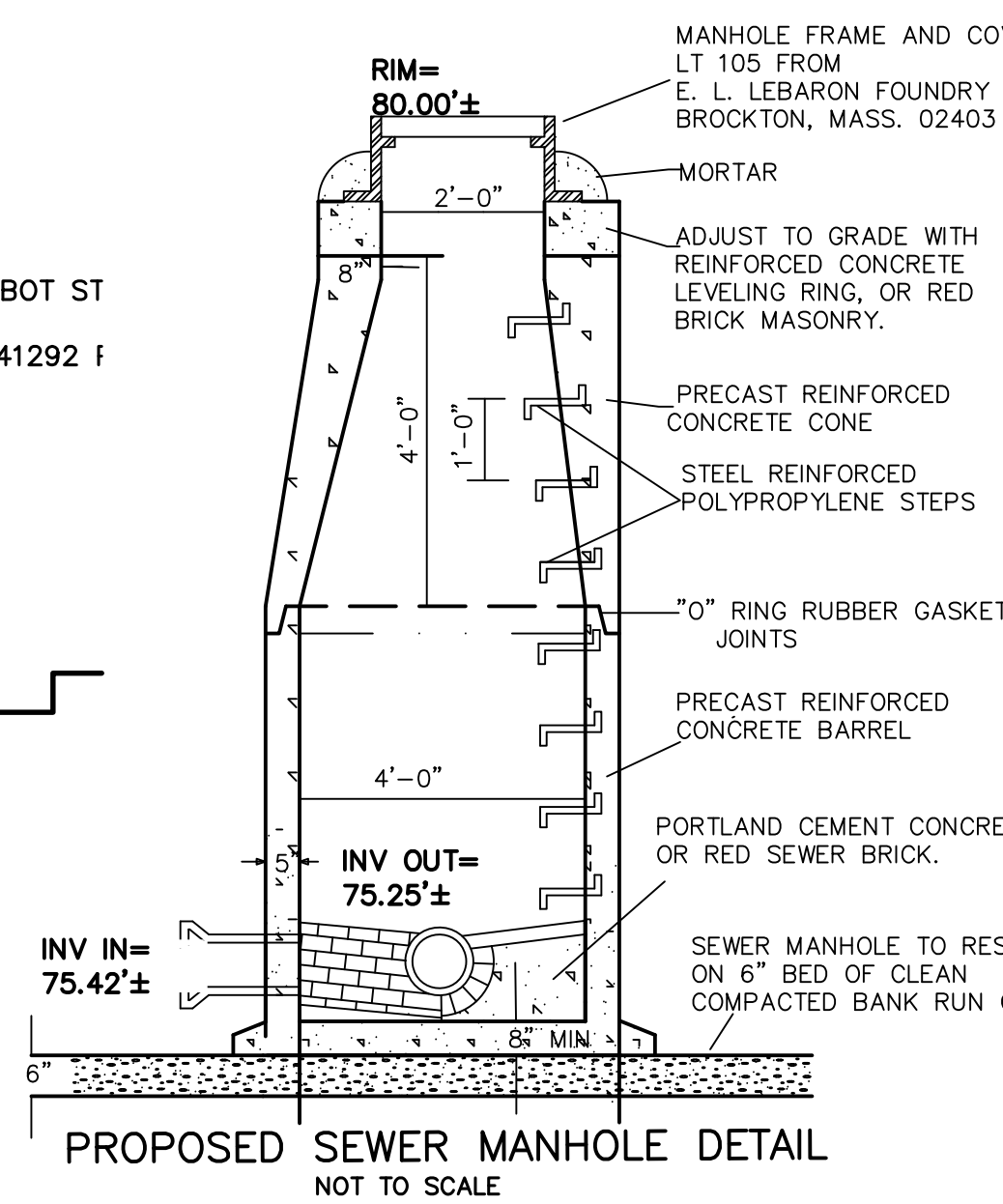

PROPOSED SEWER MANHOLE DETAIL NOT TO SCALE

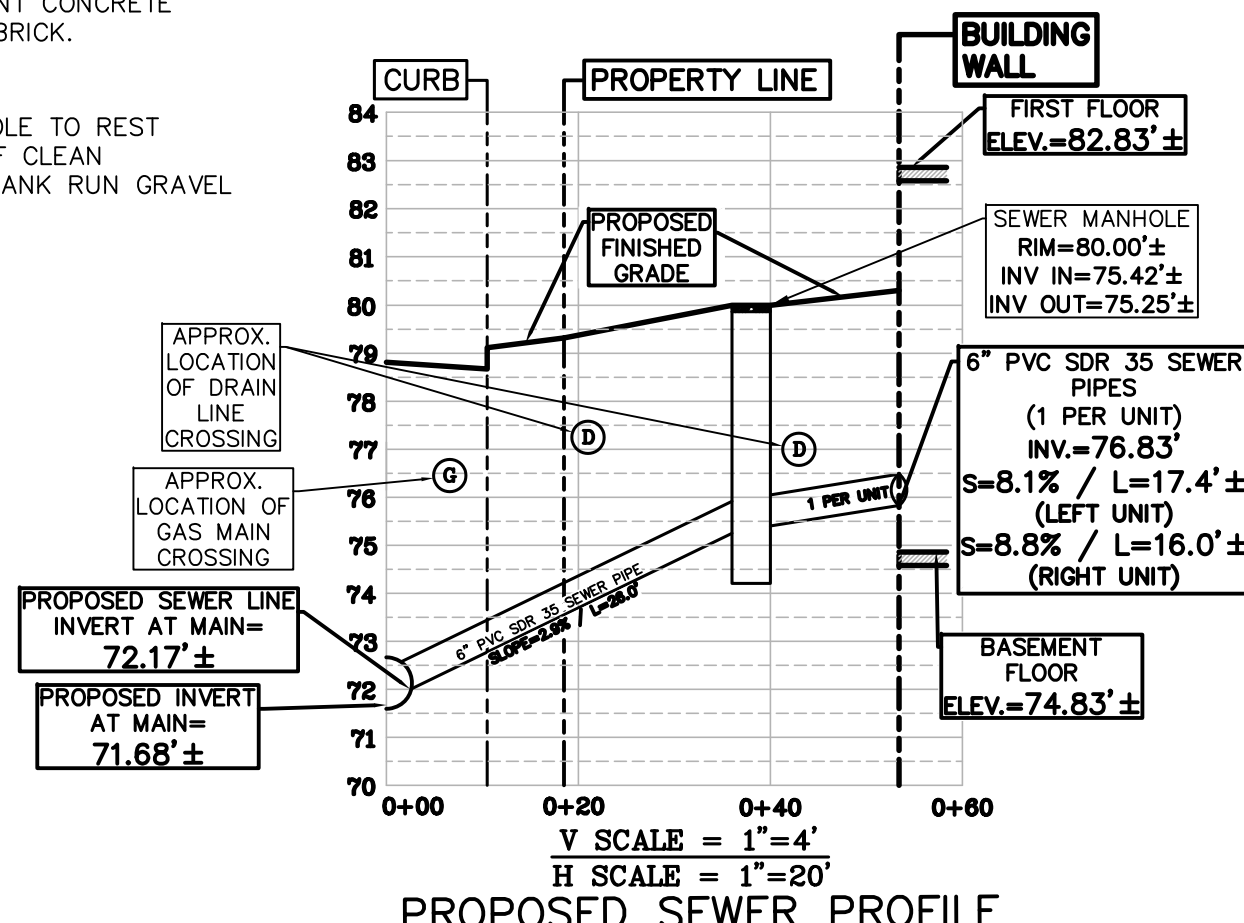

GRAPHIC SCALE (IN FEET) 1 inch = 10 ft.

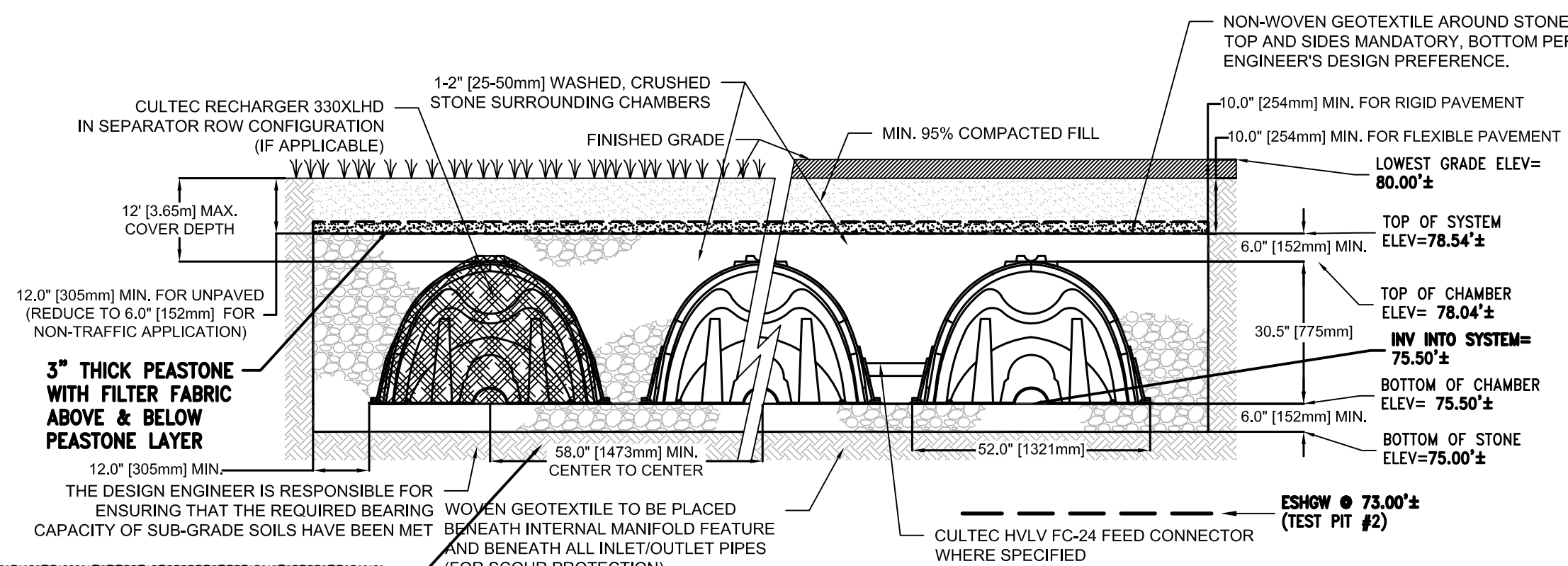

INFILTRATION SYSTEM S1

CULTEC RECHARGER 330XLHD N.T.S.

THE MATERIAL UNDER THE INFILTRATION SYSTEM #1 SHOULD BE REMOVED DOWN TO THE GRAVELLY SAND LAYER AND REPLACED WITH 2 MIN PER INCH SAND.

NOTE: DRAINAGE SYSTEM IS DESIGNED FOR 100 YEAR STORM EVENT FOR ALL RUNOFF FROM PROPOSED IMPERVIOUS AREAS SHOWN. CONTRACTOR SHALL NOT CONNECT SUMP PUMPS TO THE SYSTEM WITHOUT APPROVAL FROM THE ENGINEERING DEPARTMENT.

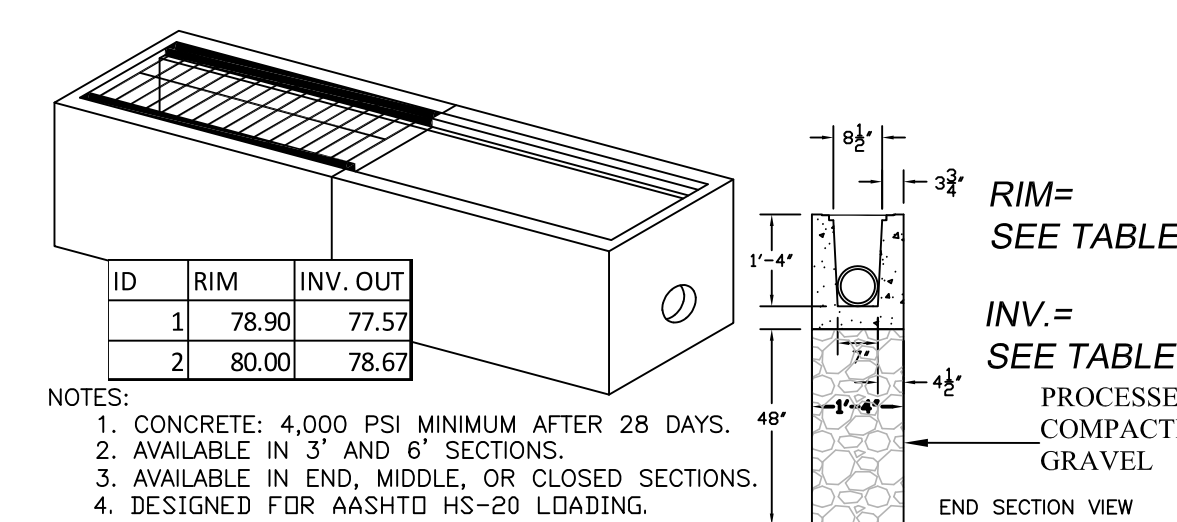

TRENCH DRAIN DETAIL

N.T.S.

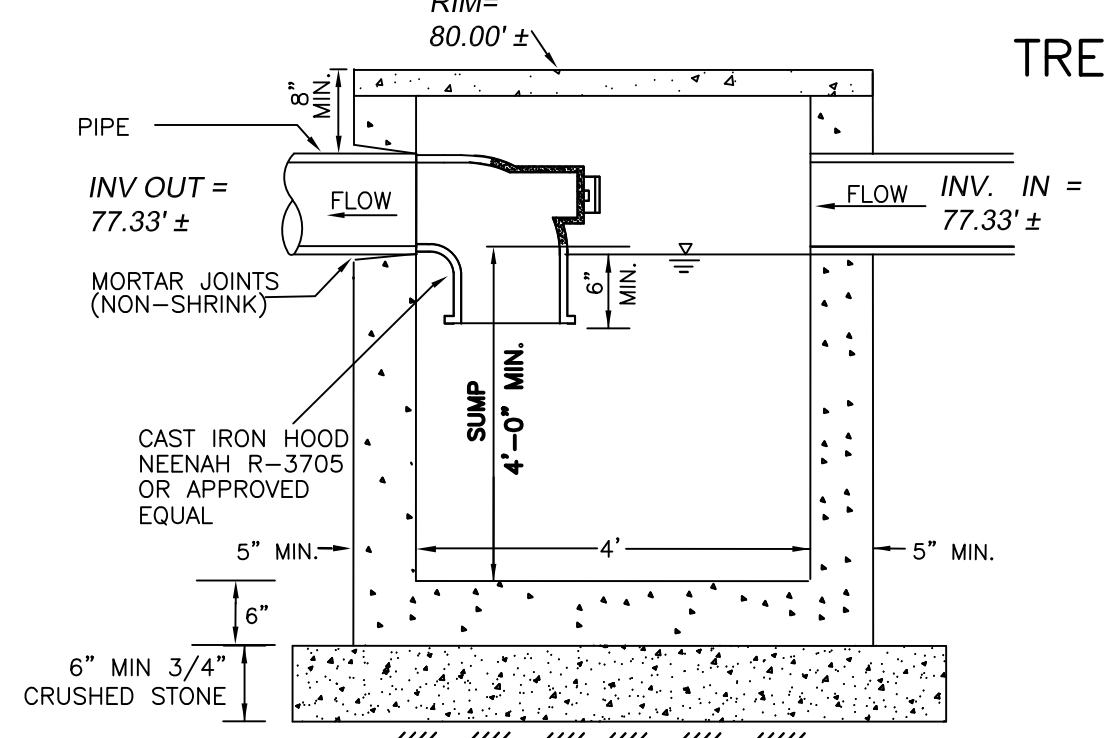

TYPICAL DRAIN MANHOLE DETAIL

N.T.S.

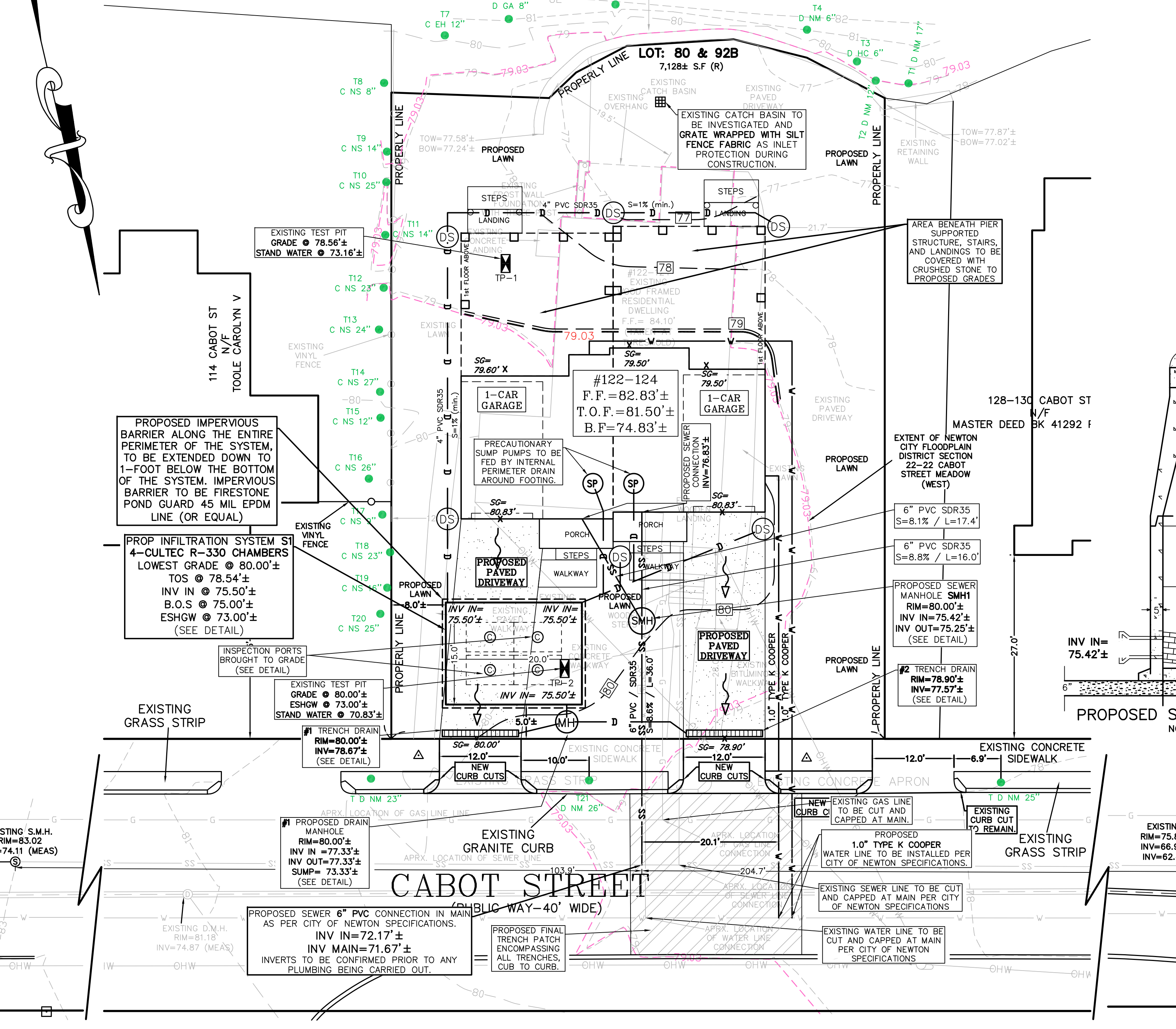

CABOT STREET

(PUBLIC WAY-40' WIDE)

NOTES

- ELEVATIONS REFER TO CITY OF NEWTON DATUM.
- THIS PLAN IS THE RESULT OF AN INSTRUMENT SURVEY DONE ON THE GROUND ON 11/29/23.
- THE LOCATIONS AND ELEVATIONS OF ALL EXISTING UTILITIES SHALL BE CONSIDERED APPROXIMATE AND MUST BE VERIFIED BY THE CONTRACTOR PRIOR TO ANY CONSTRUCTION. THE CONTRACTOR SHALL VERIFY THE LOCATIONS OF ANY CROSSINGS OF PROPOSED AND EXISTING UTILITIES.
- MASSACHUSETTS STATE LAW REQUIRES UTILITY NOTIFICATION AT LEAST THREE BUSINESS DAYS PRIOR TO CONSTRUCTION. THE CONTRACTOR SHALL CALL 800-SAFE AT 1-888-344-7233 IN ORDER TO COMPLY WITH STATE LAW.
- ALL UTILITY CONSTRUCTION SHALL CONFORM TO THE CITY OF NEWTON GENERAL CONSTRUCTION DETAILS, LATEST EDITION, PREPARED AND ISSUED BY THE NEWTON ENGINEERING DEPARTMENT. COPIES MAY BE OBTAINED AT THE OFFICE OF THE CITY ENGINEER. REFER TO NOTE 29 FOR DETAILS. NOTE: A TRENCH PERMIT MUST BE OBTAINED PRIOR TO ANY EXCAVATION BEING CARRIED OUT.
- PROPOSED SEWER PIPE SHALL BE 4" PVC SDR 35. **CONTRACTOR TO ENSURE SEWER LINE IS PITCHED AT AN EQUAL SLOPE OF BETWEEN 2% AND 10% FROM HOUSE TO MAIN CONNECTION.**
- PROPOSED WATER SERVICE SHALL BE 1" TYPE K COPPER.
- ALL WORK SHALL BE SUBJECT TO THE INSPECTION BY AND APPROVAL OF THE CITY ENGINEER.
- ALL WORK MUST BE DONE IN ACCORDANCE WITH CITY OF NEWTON STANDARD SPECIFICATIONS AND CITY OF NEWTON CONSTRUCTION DETAILS, COPIES OF WHICH MAY BE OBTAINED AT THE ENGINEERING OFFICE. ALL WORK SHALL BE SUBJECT TO INSPECTION AND APPROVAL BY THE CITY OF NEWTON ENGINEERING DEPARTMENT.
- AS OF JANUARY 1, 2009, ALL TRENCH EXCAVATION CONTRACTORS SHALL COMPLY WITH MASSACHUSETTS GENERAL LAWS CHAPTER 82A, TRENCH EXCAVATION SAFETY REQUIREMENTS, TO PROTECT THE PUBLIC FROM UNAUTHORIZED ACCESS TO UNATTENDED TRENCHES. TRENCH EXCAVATION PERMIT REQUIRED. THIS APPLIES TO ALL TRENCHES, BOTH ON PUBLIC AND/OR PRIVATE PROPERTY.
- NO EXCAVATION SHALL BE MADE BY THE CONTRACTOR IN ANY PUBLIC SUNDAYS OR HOLIDAYS, UNLESS AT LEAST FORTY-EIGHT (48) HOURS, EXCLUSIVE OF SATURDAYS, SUNDAYS, AND HOLIDAYS, BEFORE THE PROPOSED EXCAVATION IS TO BE MADE. HE HAS SUBMITTED NOTICE OF THE PROPOSED EXCAVATION TO THE FOLLOWING:
 - SUCH PUBLIC UTILITY COMPANIES AS SUPPLY GAS, ELECTRICITY, AND TELEPHONE SERVICE IN THE CITY.
 - SUCH PRIVATE COMPANIES AS PROVIDE CABLE TELEVISION SERVICE IN THE CITY.
 - CITY OF NEWTON WATER & SEWER DEPARTMENT. SUCH NOTICE SHALL SET FORTH THE STREET NAME AND A REASONABLY ACCURATE DESCRIPTION OF THE LOCATION OF THE EXCAVATION AND TELEPHONE NUMBERS TO BE CONTACTED.
- THE CONTRACTOR MUST PROVIDE POLICE DETAILS, SCHEDULED 48 HOURS IN ADVANCE, FOR THE DIRECTION AND CONTROL OF TRAFFIC, AS REQUIRED BY THE CITY ENGINEER. ALL ROADS AFFECTED BY CONSTRUCTION SHALL ALWAYS REMAIN OPEN TO EMERGENCY VEHICLES. CONTRACTOR IS TO COORDINATE WITH POLICE AND FIRE DEPARTMENT TO ENSURE PUBLIC SAFETY.
- NO WORK SHALL BE PERFORMED UNTIL THE NECESSARY PERMITS ARE OBTAINED FROM THE CITY OF NEWTON PUBLIC WORKS DEPARTMENT. THE APPLICANT WILL HAVE TO APPLY FOR STREET OPENING, UTILITIES CONNECTION, SIDEWALK CROSSING AND AN INSTALL CURB & SIDEWALK PERMIT WITH THE DPW PRIOR TO START OF WORK.
- ALL TRENCHES IN PAVED STREETS SHALL BE TEMPORARILY PATCHED WITH PAVEMENT OF EXISTING PAVEMENT THICKNESS OR AS DIRECTED BY THE CITY ENGINEERING INSPECTOR, LAID HOT AND MAINTAINED UNTIL THE PERMANENT PATCH IS INSTALLED.
- WARNING SIGNS SHALL CONFORM TO 2020 MUTCD STANDARD HIGHWAY SIGNS.
- ALL TOPSOIL, SUBSOIL OR IMPERVIOUS SOIL MUST BE EXCAVATED AND REMOVED BELOW THE LEACHING SYSTEM AND TO A DISTANCE 5' Laterally IN ALL DIRECTIONS BEYOND THE SIDES OF THE GALLEYS, BACKFILL AS REQUIRED WITH A CLEAN FINE GRAIN ORGANIC MATTER AND GLETERIOUS SUBSTANCES. THE SAND SHALL HAVE A PERCOLATION RATE OF A MINUTES PER INCH OR FASTER.
- IN CASES WHERE LEDGE OR BOULDERS ARE ENCOUNTERED, SPRUHAN ENGINEERING, P.C. WILL NOT BE RESPONSIBLE FOR THE AMOUNT OF ROCK ENCOUNTERED.
- IF ANY PART OF THIS DESIGN IS TO BE ALTERED IN ANY WAY, THE DESIGN ENGINEER, AS WELL AS THE APPROVING AUTHORITIES, SHALL BE NOTIFIED IN WRITING BEFORE CONSTRUCTION.
- THE ROOF RUNOFF FROM THE ROOF SURFACES SHALL BE COLLECTED BY GUTTERS AND DIRECTED TO THE STORM WATER DRAINAGE SYSTEM. **SURFACE WATER TO BE DIVERTED FROM ALL SIDES OF FOUNDATION WALL.**
- PRIOR TO AN OCCUPANCY PERMIT BEING ISSUED, AN AS-BUILT PLAN SHOULD BE SUBMITTED TO THE ENGINEERING DIVISION IN BOTH DIGITAL FORMAT AND HARD COPY. THE PLAN SHOULD SHOW ALL UTILITIES AND FINAL GRADES, TIES TO ALL GATES, VALVES, CLEAN-OUTS, CONNECTION POINTS AT MAINS, STRUCTURE ACCESS/MAINTENANCE COVERS, ANY EASEMENTS, SHOW DIMENSIONAL TIES FROM FIXED POINTS (FOUNDATION CORNERS) TO ALL SUBSURFACE COMPONENTS AS WELL AS FINAL GRADING. THE AS-BUILT PLAN MUST BE STAMPED, SIGNED, AND DATED BY THE ENGINEER OF RECORD.
- AFTER ALL ENGINEERING PERMITS ARE OBTAINED, THE CONTRACTOR NEEDS TO NOTIFY THE ENGINEERING DIVISION CONSTRUCTION INSPECTOR IN ADVANCE AND SCHEDULE AN APPOINTMENT TO HAVE SITE UTILITIES AND STORMWATER COMPONENTS INSPECTED. THE SYSTEM & UTILITIES MUST BE FULLY EXPOSED FOR THE INSPECTOR. ONCE THE INSPECTOR IS SATISFIED, THE SYSTEM & UTILITIES MAY BE BACKFILLED.
- THE CONTRACTOR IS RESPONSIBLE FOR NOTIFYING THE DESIGN ENGINEER FOR INSPECTIONS OR AS-BUILT LOCATIONS. **SPRUHAN ENGINEERING P.C.** WILL NOT PROVIDE AS-BUILT CERTIFICATION TO UNSPECTED BACKFILLED UTILITIES. A MINIMUM OF 48 HOURS NOTICE IS REQUIRED PRIOR TO INSPECTIONS.
- ANY PROPOSED PVC PIPES UNDER PAVING OR CONCRETE WITH LESS THAN 30" OF COVER MUST BE ENCASED IN CONCRETE. (SEE PAGE 21, CITY OF NEWTON GENERAL CONSTRUCTION DETAILS.)
- THE EXISTING WATER SERVICE MUST BE COMPLETELY REMOVED FROM THE DWELLING TO THE CORPORATION AT THE MAIN. THE CORPORATION SHALL BE CAPPED, AND A NEW TAP SHALL BE MADE FOR THE NEW SERVICE. EACH PHASE OF THIS PROCESS MUST BE INSPECTED BY A REPRESENTATIVE OF THE ENGINEERING DIVISION. FAILURE TO HAVING THIS INSPECTION PERFORMED, MAY RESULT IN THE DELAY OR DENIAL OF A WATER SERVICE PERMIT.
- THE EXISTING SEWER SERVICE MUST BE COMPLETELY REMOVED FROM THE DWELLING TO THE MAIN. THE REMOVAL, ALONG WITH THE NEW CONNECTION MUST BE INSPECTED BY A REPRESENTATIVE OF THE ENGINEERING DIVISION. FAILURE TO HAVING THESE INSPECTIONS PERFORMED, MAY RESULT IN THE DELAY OR DENIAL OF A SEWER SERVICE PERMIT.
- THE NEW SEWER SERVICE(S) AND/OR MANHOLES SHALL BE VACUUM TESTED IN ACCORDANCE WITH THE DPW STANDARDS METHOD OF FINAL INSPECTION SHALL BE DETERMINED SOLELY BY THE CONSTRUCTION INSPECTOR FROM THE CITY ENGINEERING DIVISION. THE SEWER SERVICE WILL NOT BE ACCEPTED UNTIL ONE OF THE TWO METHODS STATED ABOVE IS COMPLETED. A CERTIFICATE OF OCCUPANCY WILL NOT BE RECOMMENDED UNTIL ALL PIPING AND STRUCTURES ARE TESTED AND PASS.
- THE NEW WATER SERVICE SHALL BE INSTALLED IN CONJUNCTION WITH THE CITY OF NEWTON UTILITIES DIVISION. THE OWNER/CONTRACTOR MAY OBTAIN A WATER SERVICE APPLICATION BY CONTACTING THE UTILITIES DIVISION (617) 796-1840 OR BY VISITING THE CITY OF NEWTON WEBSITE AND CLICK THE LINK FOR PUBLIC WORKS / UTILITIES DIVISION. AFTER THE APPLICATION IS PAID IN FULL THE OWNER/CONTRACTOR SHALL FOLLOW THE INSTRUCTIONS PLAN NOTES MENTIONED AND FOLLOWING.
- THE EXISTING CONTOURS OF THE LAND ARE NOT TO BE ALTERED BY MORE THAN THREE (3) FEET AS A RESULT OF THE PLACEMENT OR REMOVAL OF SOIL, LOAM, CLAY OR OTHER SOLID MATERIAL UNLESS A PROPOSED RETAINING WALL OR SWALE IS INSTALLED AFTER IT IS APPROVED BY BOTH CITY OF NEWTON ENGINEERING DEPARTMENT & CITY OF NEWTON I.S.D.
- NO EXCAVATION IS ALLOWED WITHIN ANY CITY RIGHT-OF-WAY BETWEEN NOVEMBER 15TH AND APRIL 15TH IF ANY EMERGENCY ARRESTS OR THERE ARE EXTENUATING CIRCUMSTANCES. THE APPLICANT MUST OBTAIN PERMISSION FOR SUCH WORK FROM THE CITY DPW COMMISSIONER VIA THE CITY ENGINEER. IF PERMISSION IS GRANTED, SPECIAL CONSTRUCTION STANDARDS WILL BE APPLIED. APPLICANT OR APPLICANT'S REPRESENTATIVE MUST CONTACT THE CITY OF NEWTON ENGINEERING DEPARTMENT PRIOR TO START OF WORK FOR CLARIFICATION.
- AT THE END OF CONSTRUCTION, ALL DRAINAGE STRUCTURES ARE TO BE CLEANED OF SILT, STONES AND OTHER DEBRIS.
- DURING CONSTRUCTION, THE EROSION CONTROL MEASURES SHALL BE INSPECTED ONCE PER WEEK AND WITHIN 24 HOURS OF ANY SITE ACTIVITY GENERATING MORE THAN 1/2" OF RAINFALL. THE EROSION CONTROL MEASURES SHALL BE CLEANED REGULARLY AND ADJUSTED IF NECESSARY TO ENSURE THAT NO SILT OR DEBRIS LEAVES THE SITE.
- EXCEPT FOR GAS SERVICES, ALL UTILITY TRENCHES WITHIN THE CITY OF NEWTON RIGHT-OF-WAY WILL BE BACK FILLED WITH TYPE IE (EXCAVATABLE) CONTROLLED DENSITY FILL AS SPECIFIED BY THE CITY OF NEWTON ENGINEERING SPECIFICATIONS. EXCAVATABLE FLOW FILL WITH EXTEND TO WITHIN 18" OF ROADWAY ASPHALT.
- ALL CONSTRUCTION ACTIVITIES WITHIN THE CITY OF NEWTON RIGHT-OF-WAY MUST FULLY COMPLY WITH ALL OF CITY OF NEWTON CONSTRUCTION SPECIFICATIONS AS WELL AS 521 CMR 21.00 AND 22.00.
- ALL SILTATION CONTROL NEEDS TO BE INSTALLED PRIOR TO ANY CONSTRUCTION. THE CONTRACTOR SHALL CONTACT THE CITY ENGINEER'S OFFICE FOR APPROVAL PRIOR TO COMMENCEMENT.
- ALL TRENCH EXCAVATION CONTRACTORS SHALL COMPLY WITH MGL CHAPTER 82A, TRENCH EXCAVATION SAFETY REQUIREMENTS, TO PROTECT THE GENERAL PUBLIC FROM UNAUTHORIZED ACCESS TO UNATTENDED TRENCHES. A TRENCH EXCAVATION PERMIT IS REQUIRED.
- APPROVAL OF THIS PLAN BY CITY OF NEWTON ENGINEERING DIVISION IMPLIES THAT THE PLAN MEETS THE MINIMAL DESIGN STANDARDS OF THE CITY OF NEWTON. HOWEVER, THE ENGINEERING DIVISION MAKES NO REPRESENTATION AND ASSUMES NO RESPONSIBILITY IN TERMS OF SUITABILITY FOR THE PARTICULAR SITE CONDITIONS OR OF THE FUNCTIONABILITY OR PERFORMANCE OF ANY ITEMS CONSTRUCTED IN ACCORDANCE WITH THE DESIGN(S). THE CITY OF NEWTON ASSUMES NO LIABILITY FOR DESIGN ASSUMPTION, ERRORS OR OMISSIONS BY THE CONTRACTOR.
- PER CITY OF NEWTON ORDINANCE NOB-42, COUNCIL ITEM #251-19, BUILDING SEWER, WATER SERVICE PIPE & SIDEWALK/CURB REPLACEMENT ORDINANCE, THE APPLICANT IS REQUIRED TO INSTALL/REPLACE SIDEWALK & CURB ALONG THE ENTIRE FRONTAGE. THIS SHALL INCLUDE APPROPRIATE TRANSITION TO ADJOINING CURBS & WALKWAYS, INCLUDING ACCESSIBLE CURB CUTS & OTHER ACCESS AS REQUIRED. THE ENGINEERING CONSTRUCTION INSPECTOR MAKES A DETERMINATION, BASED ON THE MATERIAL & MANNER OF CONSTRUCTION OF THE EXISTING SIDEWALK & CURB, THAT THE EXISTING SIDEWALK & CURB HAS THE ABILITY TO BE RE-SET OR REBUILT WITHOUT REPLACEMENT.
- THE CONTRACTOR IS RESPONSIBLE FOR NOTIFYING THE DESIGN ENGINEER FOR INSPECTIONS AND AS-BUILT LOCATIONS. THE ENGINEER OF RECORD IS RESPONSIBLE FOR THE ON-SITE INSPECTION(S) OF ALL SUBSURFACE STRUCTURES. THIS INCLUDES BUT NOT LIMITED TO DRAINAGE, UTILITIES (INCLUDING SEWER PIPE SLOPE), ROOF LEADER COLLECTION SYSTEM, TRENCH DRAINS, MANHOLES ETC. ENGINEER OF RECORD MUST ALSO CONDUCT BOTTOM(S) OF HOLE INSPECTION(S) PRIOR TO SUBSURFACE DRAINAGE SYSTEMS BEING INSTALLED. **CONTRACTOR TO NOTIFY ENGINEER BEFORE BACKFILL OR SIGN OFF CANNOT OCCUR WITHOUT RE-EXCAVATION.**
- PLEASE SEE SECTION 6-C REQUIREMENT #6 OF THE STORMWATER MANAGEMENT AND EROSION CONTROL PLAN & REGULATORY REQUIREMENTS TO PROTECT THE GENERAL PUBLIC FROM UNAUTHORIZED ACCESS TO UNATTENDED TRENCHES. A TRENCH EXCAVATION PERMIT IS REQUIRED.
 - ALL MATERIALS TO MEET SPECIFICATION.
 - SILT SOCK COMPOST/SOIL/ROCK/SEED FILL TO MEET APPLICATION REQUIREMENTS.
 - SILT SOCK DEPICTED IS FOR MINIMUM SLOPES. GREATER SLOPES MAY REQUIRE LARGER SOCKS PER THE ENGINEER.
 - COMPOST MATERIAL TO BE DISPERSED ON SITE AS DETERMINED BY ENGINEER.
- 5 YEAR MORATORIUM - IF AT TIME OF CONSTRUCTION THE ROADWAY IS UNDER A 5 YEAR MORATORIUM, THE ROADWAY MUST BE MILLED & PAVED GUTTER-TO-GUTTER FOR A DISTANCE OF 25 FEET IN EACH DIRECTION FROM THE OUTERMOST TRENCHES OR AS DIRECTED BY THE ENGINEERING INSPECTOR.

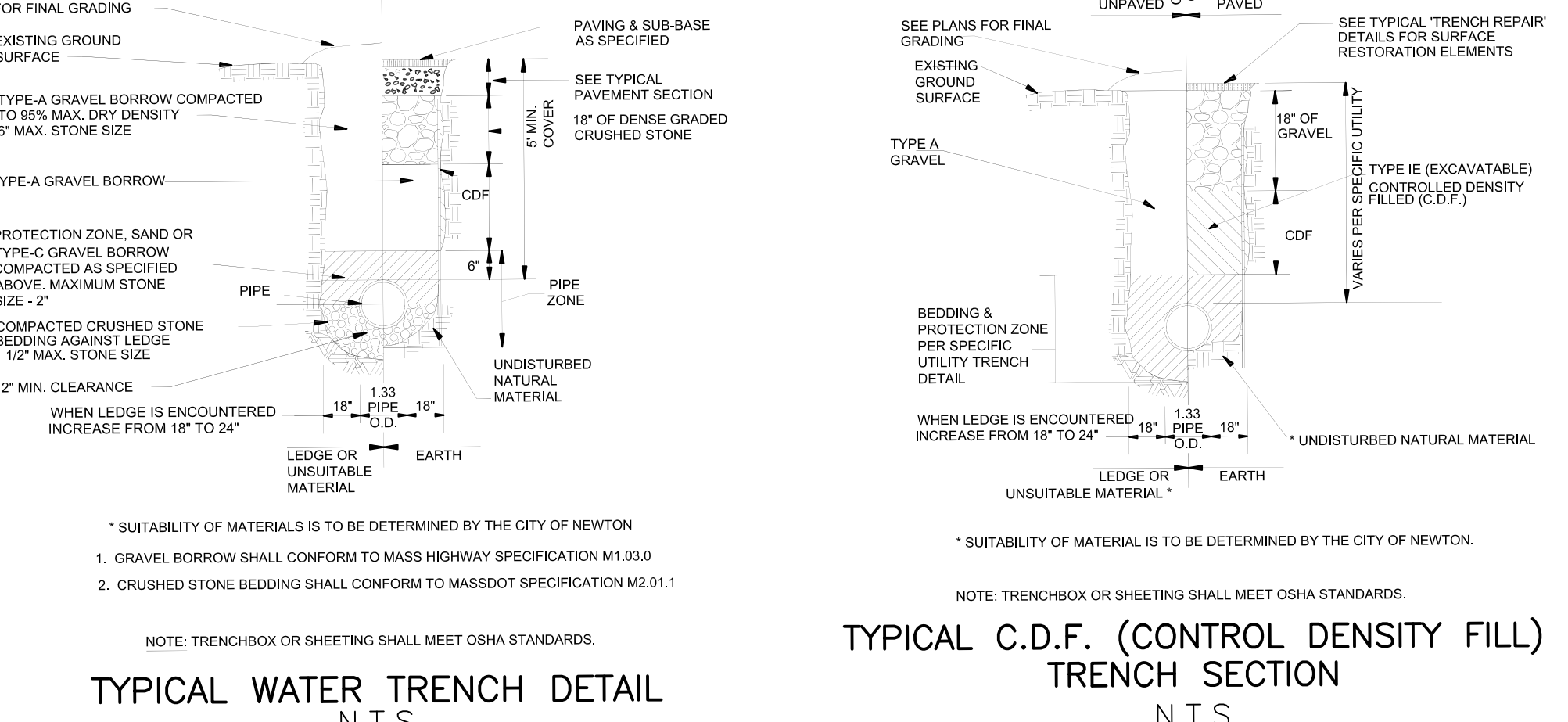
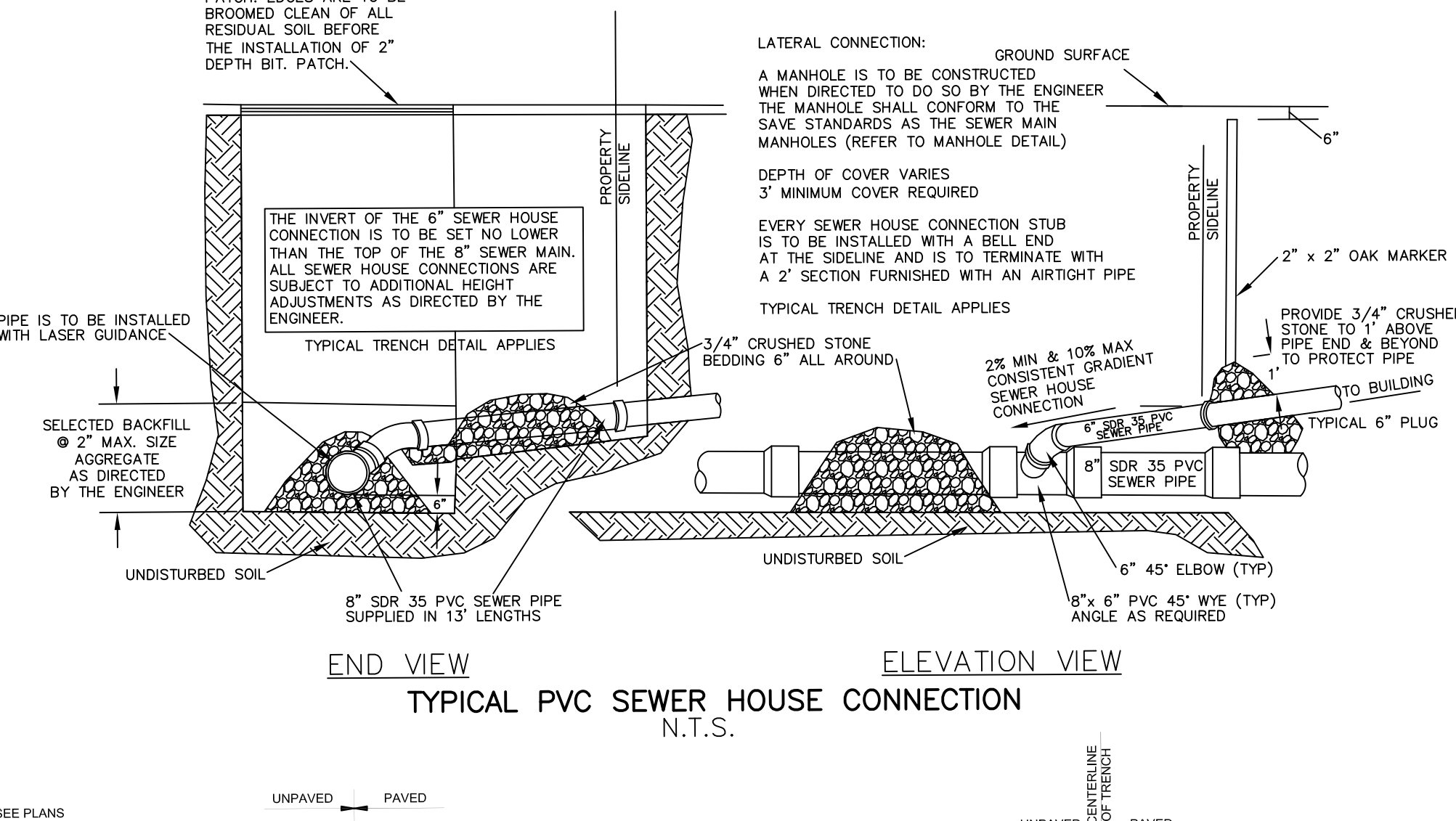
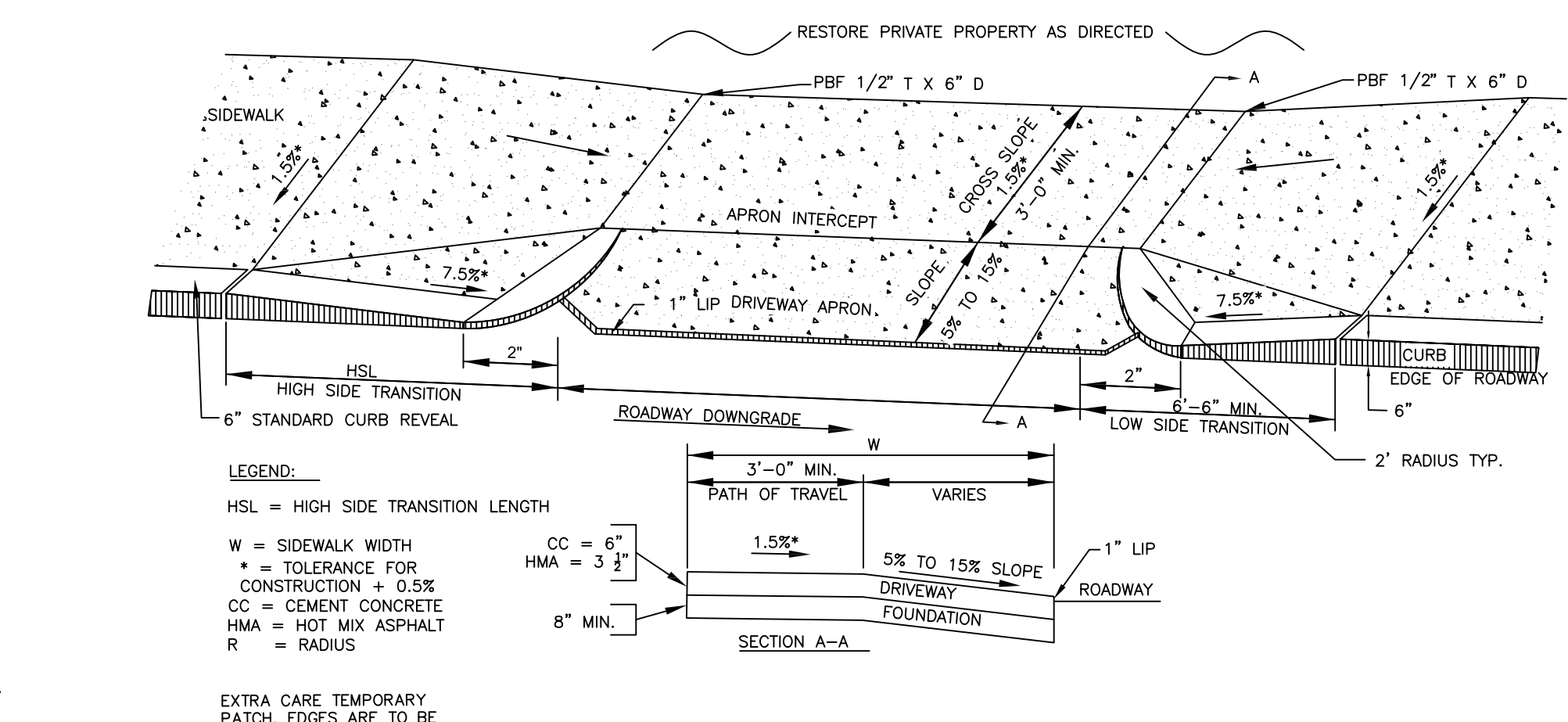
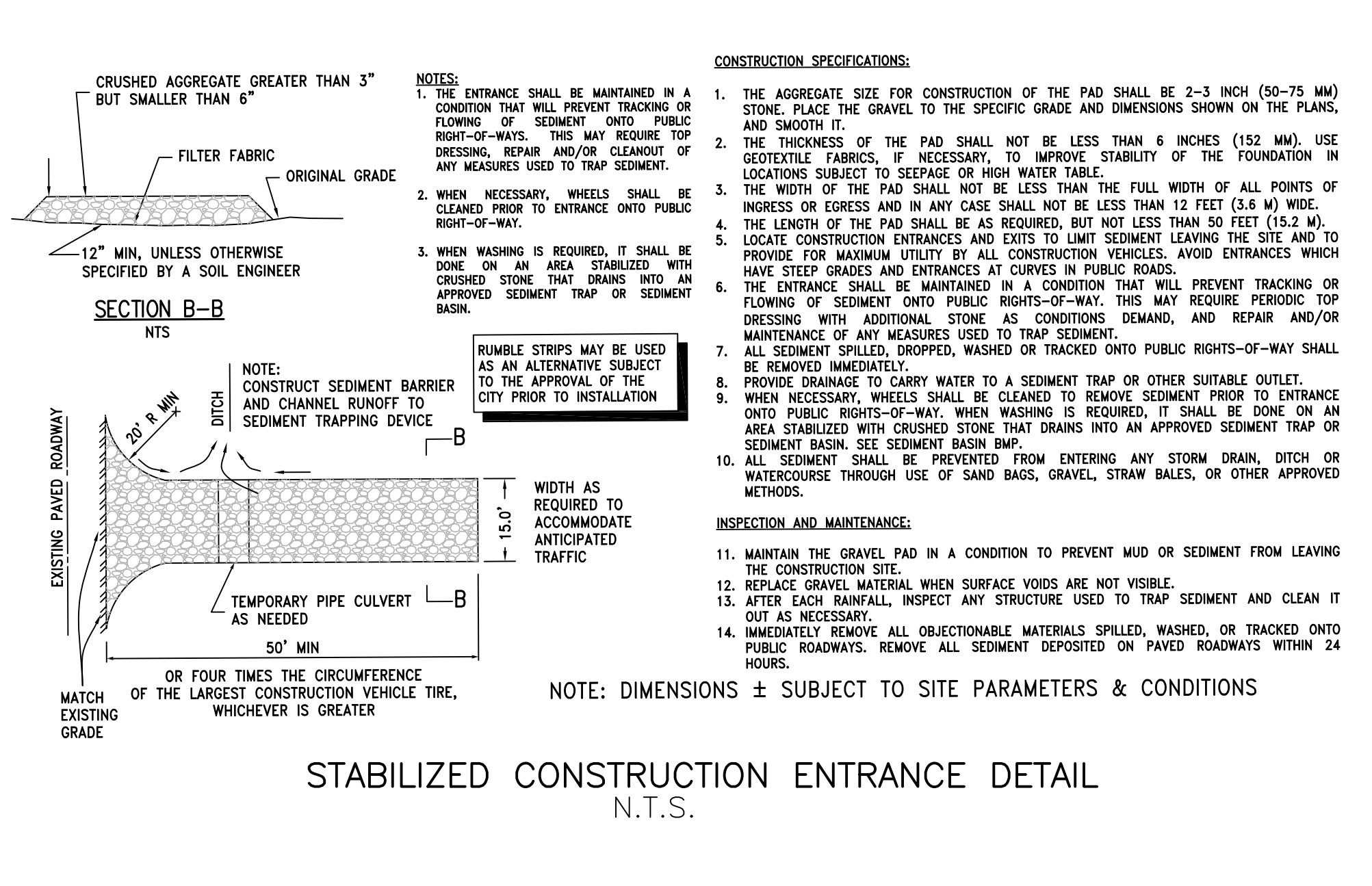
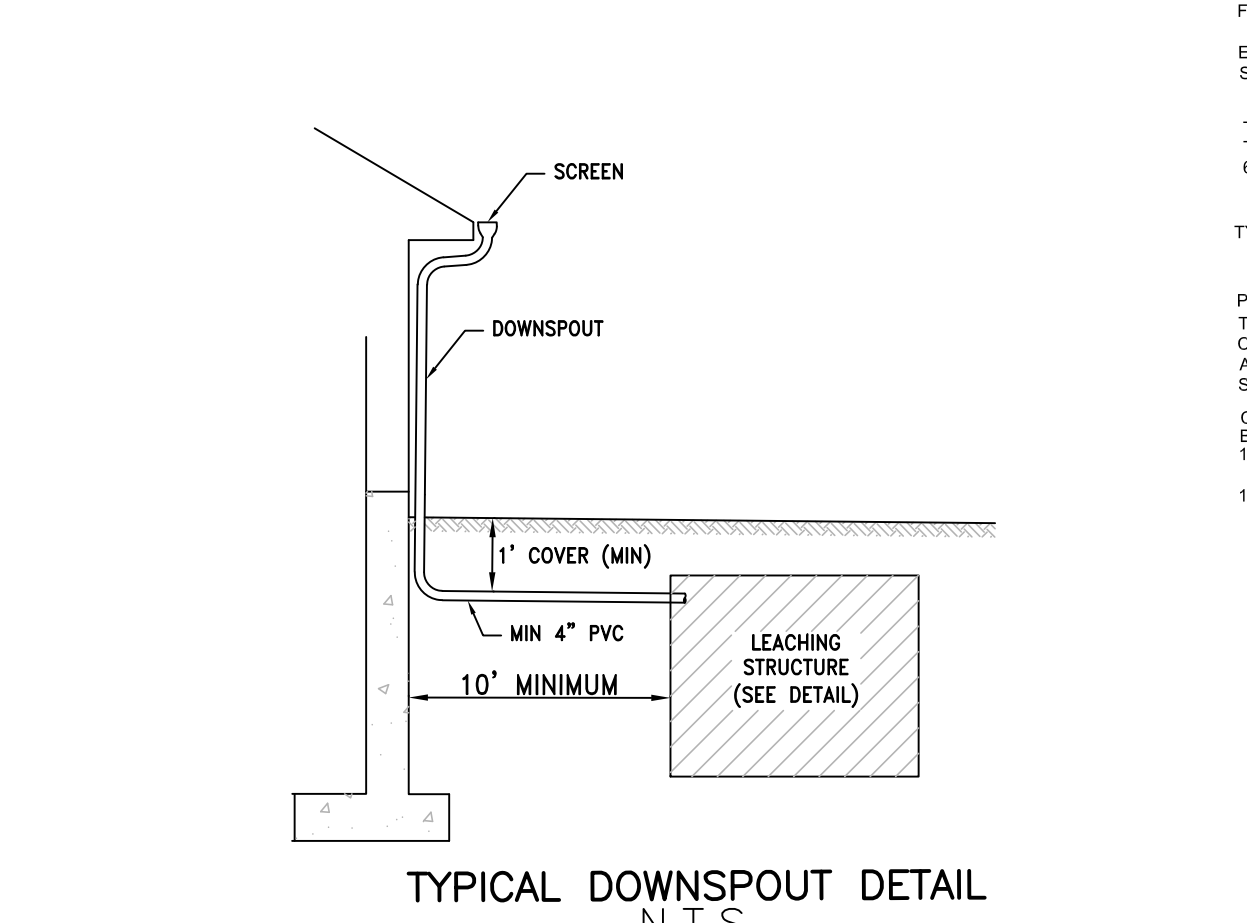
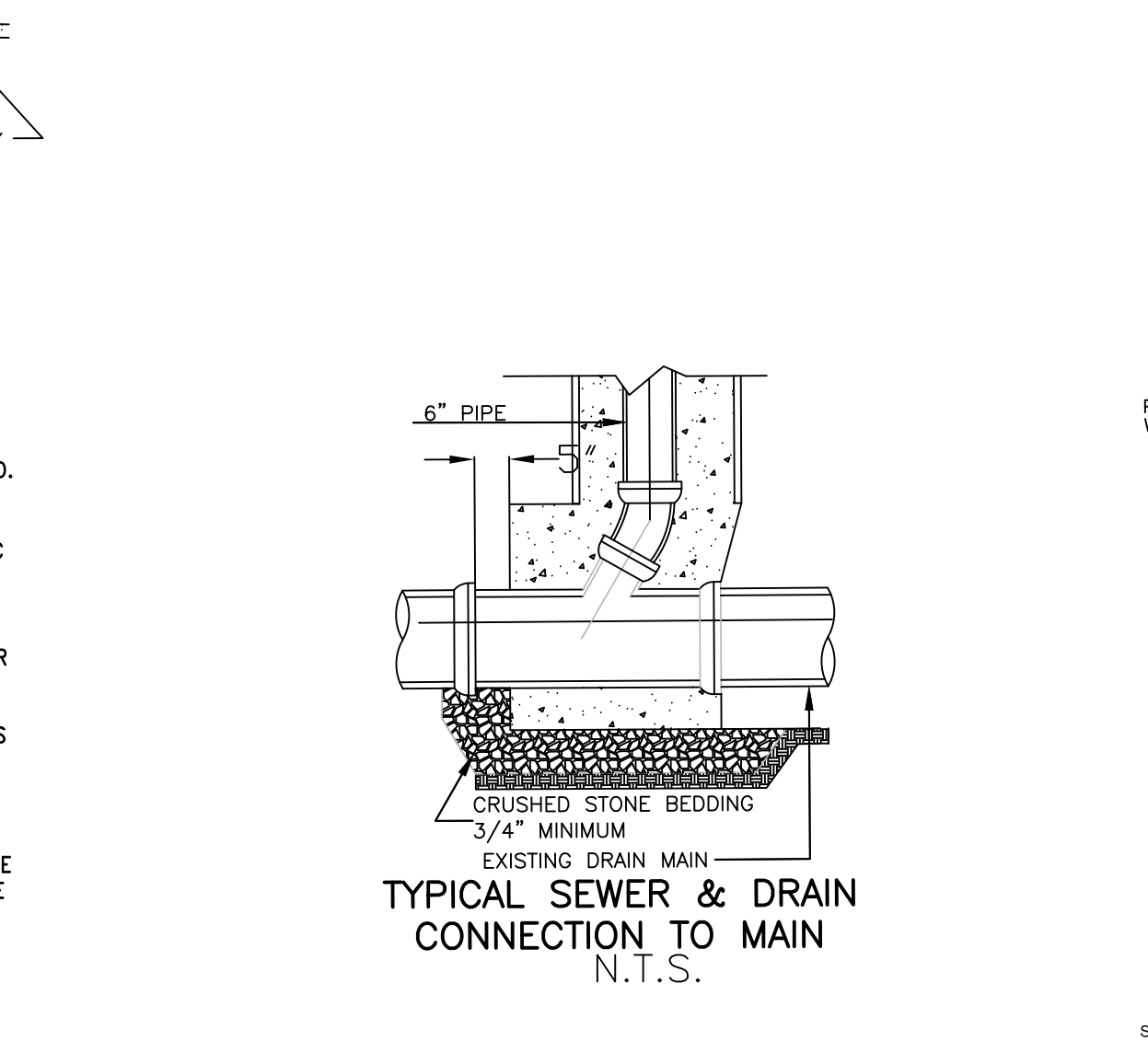
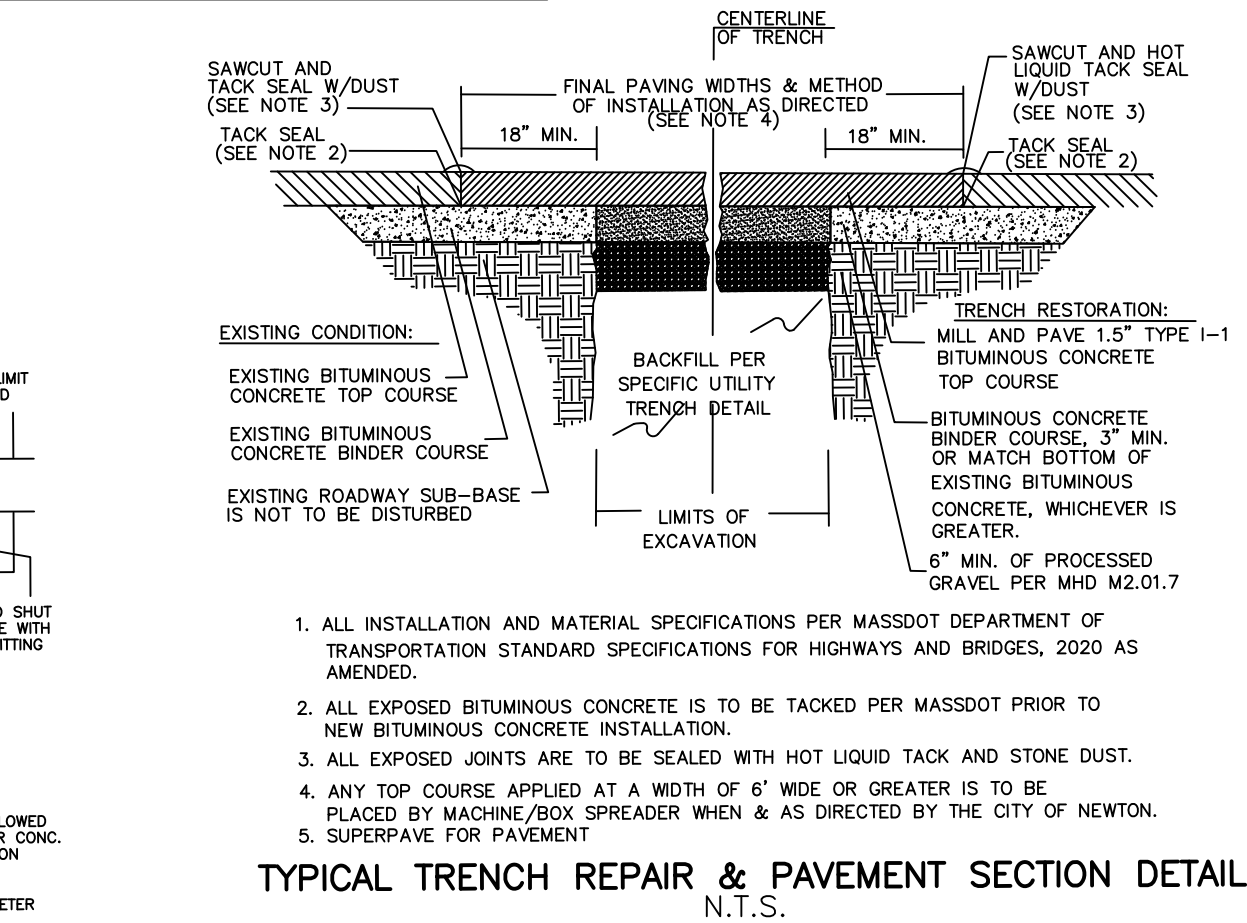
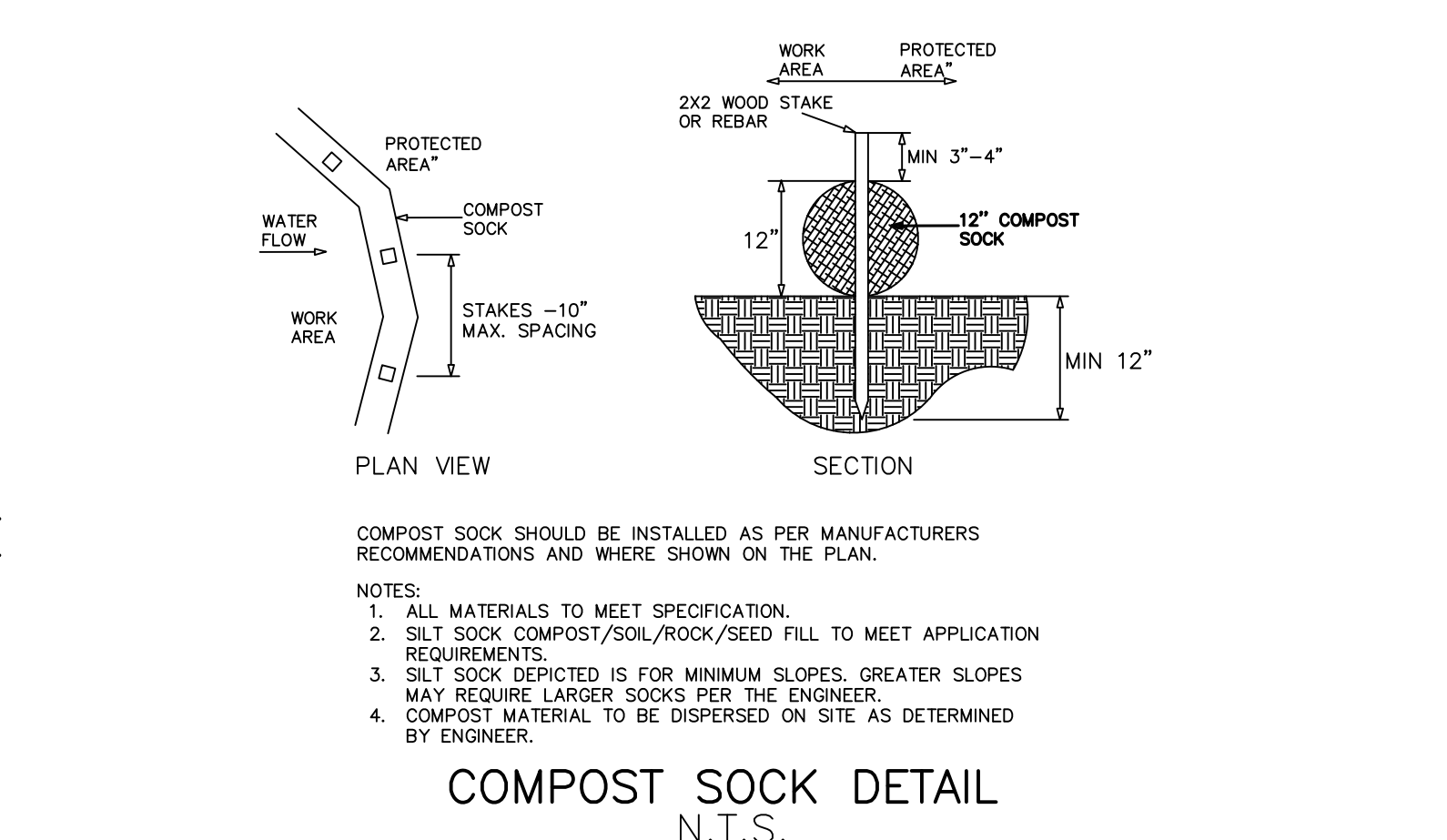
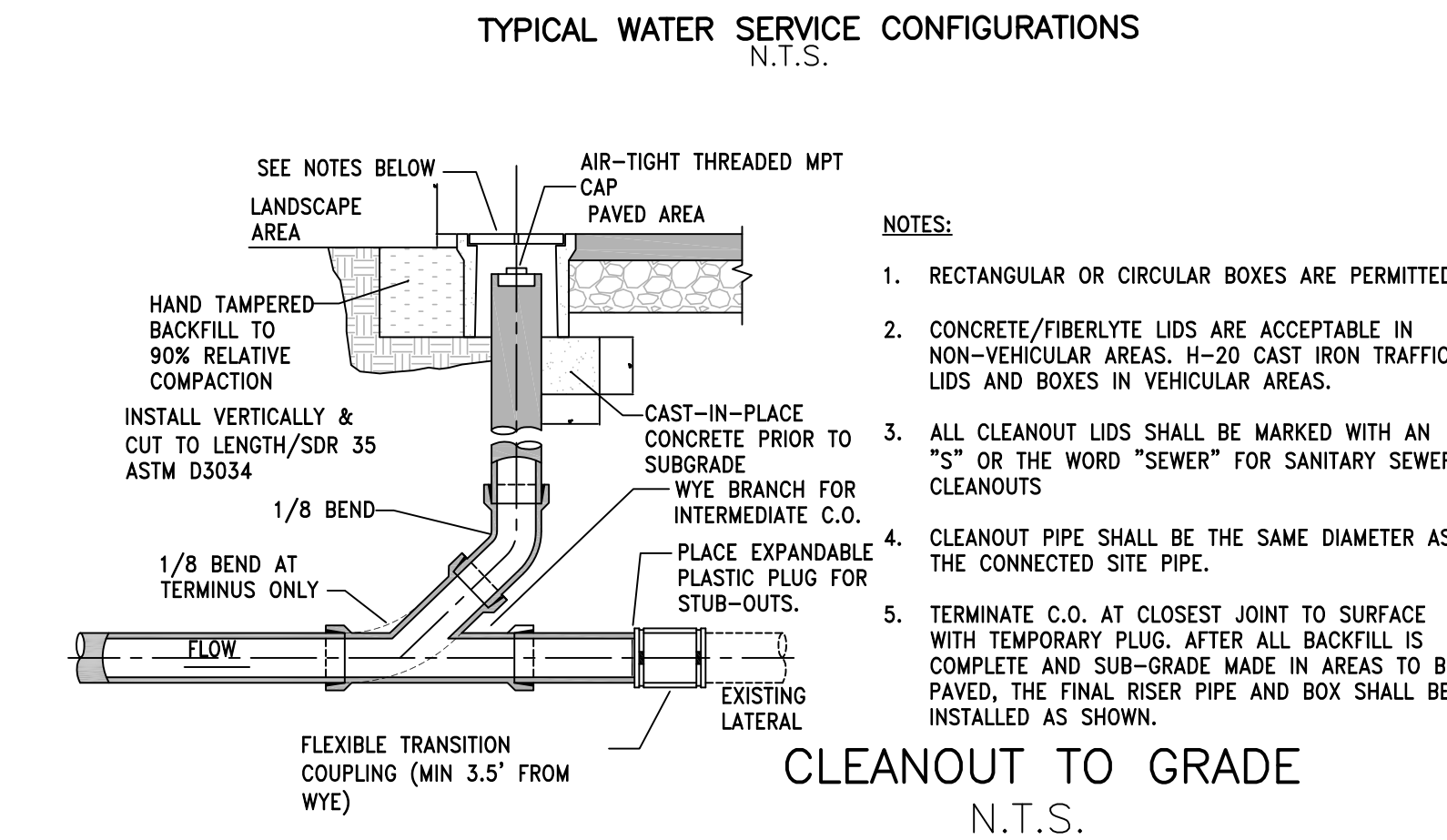
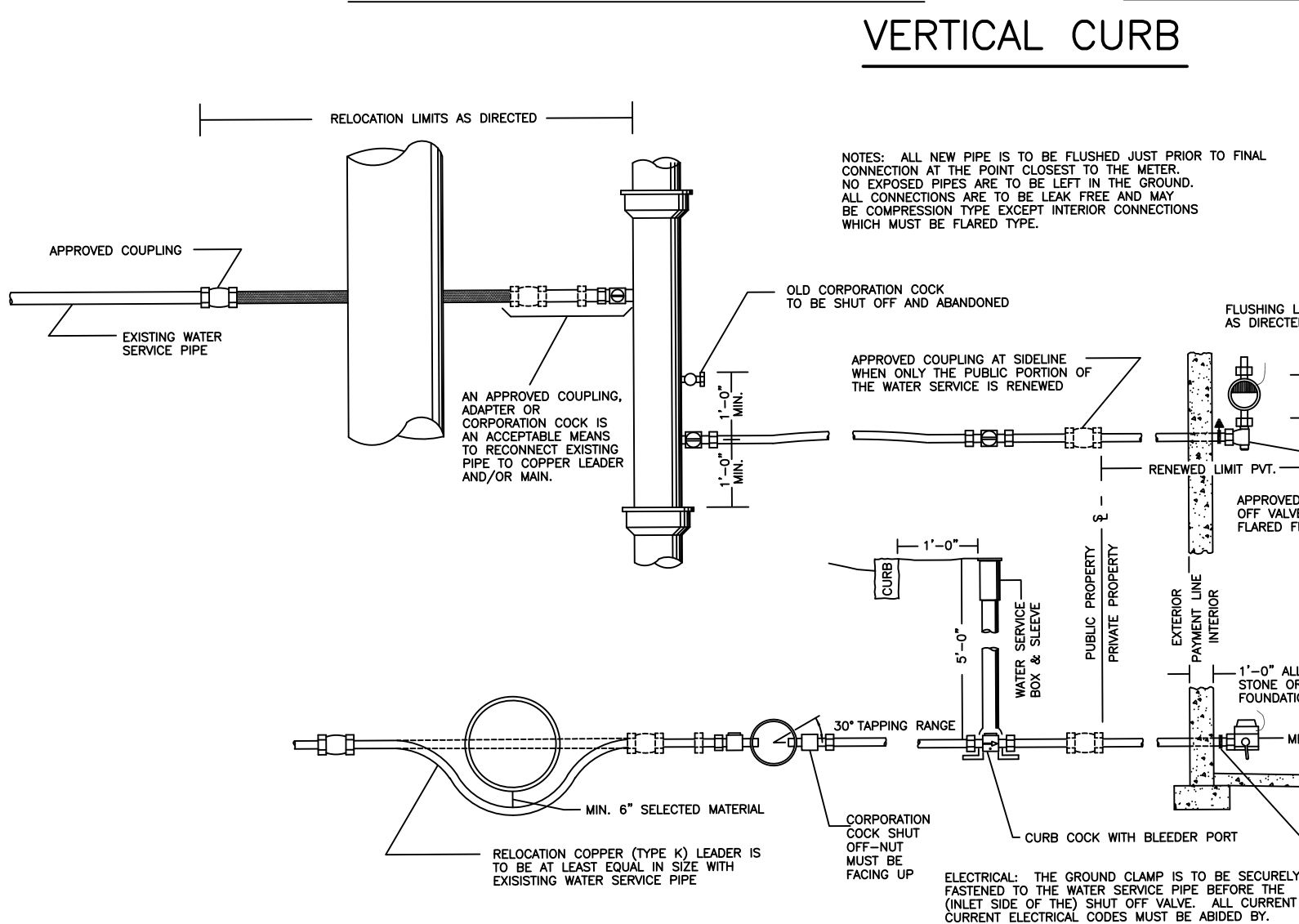
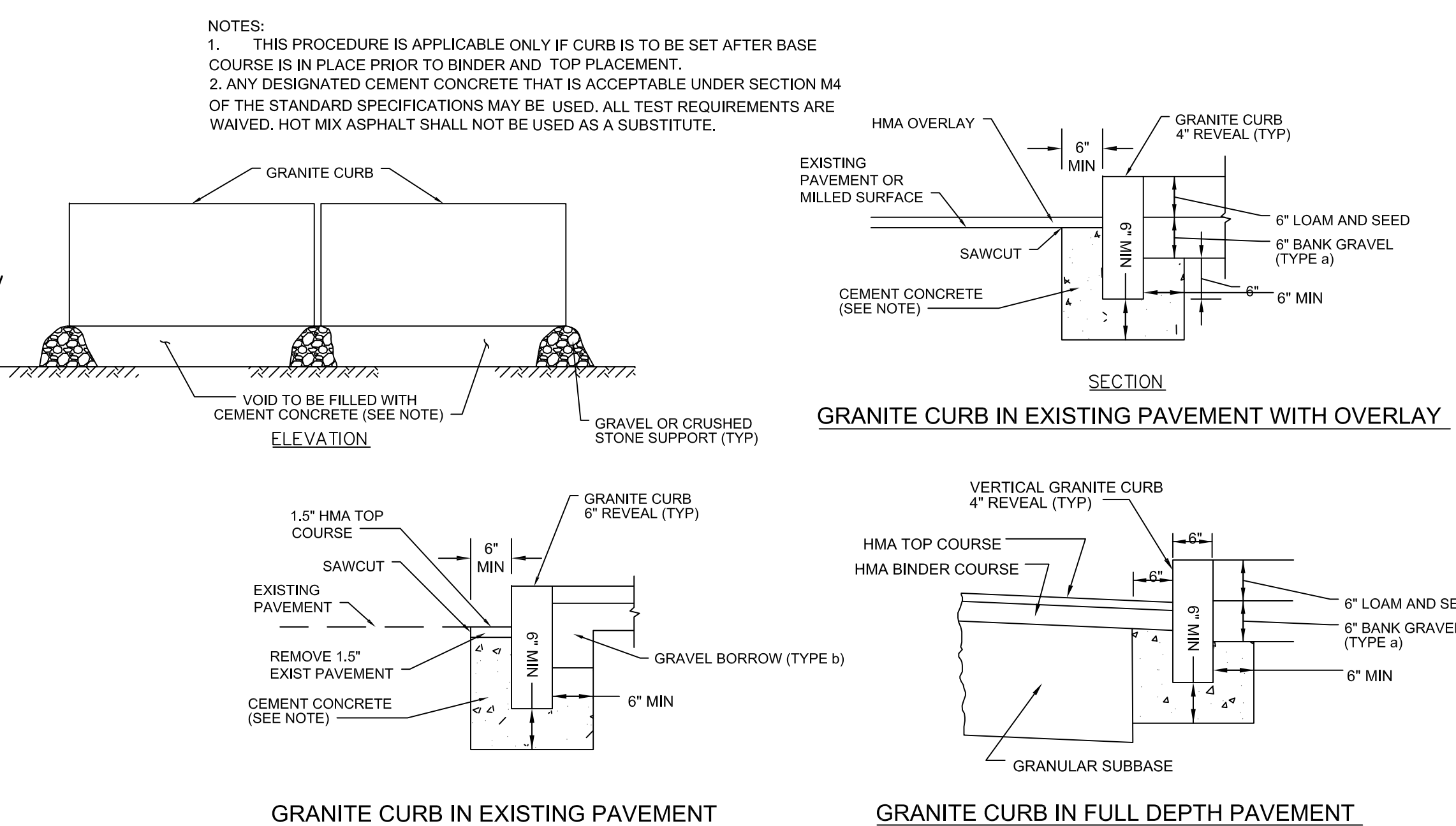

Spruhan Engineering, P.C.
80 JEWETT ST, (SUITE 1)
NEWTON, MA 02458
Tel: 617-816-0722
Email: edmond@spruhaneng.com

122-124 CABOT STREET NEWTON MASSACHUSETTS

SITE PLAN

REVISION BLOCK

BY	DESCRIPTION	DATE

All legal rights including, but not limited to, copyright and design patent rights, in the designs, arrangements and plans shown on this document are the property of Spruhan Engineering, P.C. They may not be used or reused in whole or in part, except in connection with this project, without the prior written consent of Spruhan Engineering, P.C.. Written dimensions on these drawings shall have precedence over scaled dimensions. Contractors shall verify and be responsible for all dimensions and conditions on this project, and Spruhan Engineering, P.C., must be notified of any variation from the dimensions and conditions shown by these drawings.

4/25/25

DATE: 4/25/25
DRAWN BY: H.M.S.
CHECKED BY: E.S.
APPROVED BY: E.S.

DETAILS SHEET 1

SHEET 5 OF 6

