

7.

Evidence of Similar Use/
Similar Exceptions to
Zoning Rules

No change to the essential character of the Neighborhood



572 Dedham Street paving project

Inspector Intake Initials & Date Stamp
 RECEIVED
 INSPECTIONAL SERVICES
 NEWTON, MA
 2022 MAR 14 AM 11:41

City of Newton, Massachusetts
 Inspectional Services Department
 1000 Commonwealth Avenue
 Newton, Massachusetts 02459

Permit No.: 22030104
 Date Issued: 3/14/2022
 Date Received: 3/14/2022

APPLICATION FOR PLAN EXAMINATION AND BUILDING PERMIT

IMPORTANT: APPLICANTS MUST COMPLETE ALL ITEMS ON THIS PAGE

LOCATION INFORMATION

Inspector: PG Zoning District: SR2

Location: 572 Dedham Street, Newton Year Built: 1930

Section: 81 Block: 01 Lot: 12 Condominium: Yes No

Historic Preservation: Yes No Conservation: Yes No

TYPE AND USE OF BUILDING

Type of Improvement

- New Building
- Addition
- Alteration
- Demolition
- Repair, Replacement
- Signage
- Temporary Tent
- Other: _____

Proposed Use: Residential

- Single Family
- Two Family
- 3 or more Family
No. of Units: _____
- Garage
- Other: _____

Proposed Use: Non-Residential

- Commercial
- Industrial
- Hospital, Institutional
- Church, other Religious
- Public
- Wireless Communication
- Other: _____

Description of work to be performed: REPLACE EXISTING DRIVEWAY, NO CHANGE TO LAYOUT

City Council; Special Permit #: _____ Zoning Board of Appeals; Variance; Petition #: _____

IDENTIFICATION (PLEASE TYPE OR PRINT CLEARLY)

Property Owner: Name: Aamir Masood Phone: (781) 775-5930

Address: 572 Dedham Street, Newton

Contractor: Name: ASPHALT ENGINEERING Phone: 508-541-8300

Address: 190 FARM STREET BELLINGHAM, MA 02019

Supervisor's Construction License: _____ Exp. Date: _____

Home Improvement Registration: _____ Exp. Date: _____

Contractor ID #: 02343

Architect/Engineer: Name: _____ Phone: _____

Address: _____ Reg. No.: _____

SIGNATURES: *Note: Persons contracting with unregistered contractors do not have access to the guaranty fund.

Aamir Masood
 SIGNATURE OF AGENT/OWNER

Sumit Segal
 SIGNATURE OF CONTRACTOR

DEBRIS REMOVAL: CONSTRUCTION DEBRIS IS NOT TO BE DISPOSED OF IN THE CITY OF NEWTON TRASH COLLECTION SYSTEM

Section 105.3.1.2 780 CMR, Mass. State Building Code states: ".... A condition of issuing a permit for the demolition, renovation, rehabilitation, or other alteration of a building or structure, M.G.L. Ch. 40 § 54, requires that the debris resulting therefrom shall be disposed of in a properly licensed said waste disposal facility* as defined by M.G.L.Ch.111, § 150 A."

71 SPRING STREET ASHLAND- AGGREGATE INDUSTRIES

*Location of Facility or Dumpster Company's Name and Address

DEMOLITION ONLY; DUST CONTROL – Choose one of the following options below

Water Truck Hydrant Meter (Requested through Engineering Dept; Not available Nov. 15th to April 15th)

WATER & SEWER SERVICE: Dwelling or structure built prior to 1970; Gutting more than 50% or increase of more than 1,000 sq ft new water and sewer must be installed (Refer to Engineering Department for policy)

Gutting more than 50%: Yes No Increase of more than 1,000 sq ft: Yes No

FEE SCHEDULE: Computed at a rate of \$20.00 per \$1,000.00 of estimated construction cost including any fraction thereof, ROUNDED UP TO THE NEAREST THOUSAND provided however, that in no event shall the fee be less than the minimum fee of \$50.00 for residential and \$100.00 for commercial

Total cost of the job: \$ 12000 X .02 = FEE \$ 240

Check No.: 2524 Receipt No.: 02000020310

THE FOLLOWING SECTIONS FOR OFFICE USE ONLY

DEPARTMENT APPROVALS	APPROVED	DISAPPROVED	NOT APPLICABLE
Planning and Development	<input type="checkbox"/> _____	<input type="checkbox"/> _____	<input type="checkbox"/> _____
Conservation	<input type="checkbox"/> _____	<input type="checkbox"/> _____	<input type="checkbox"/> _____
Historic	<input type="checkbox"/> _____	<input type="checkbox"/> _____	<input type="checkbox"/> _____
Health Department	<input type="checkbox"/> _____	<input type="checkbox"/> _____	<input type="checkbox"/> _____
Fire Department	<input type="checkbox"/> _____	<input type="checkbox"/> _____	<input type="checkbox"/> _____
Engineering Department	<input type="checkbox"/> _____	<input type="checkbox"/> _____	<input type="checkbox"/> _____

COMMENTS/NOTES:

BUILDING PERMIT APPROVED AND ISSUED BY: _____



Updated July 2020



Property Address: 572 Dedham St, Newton

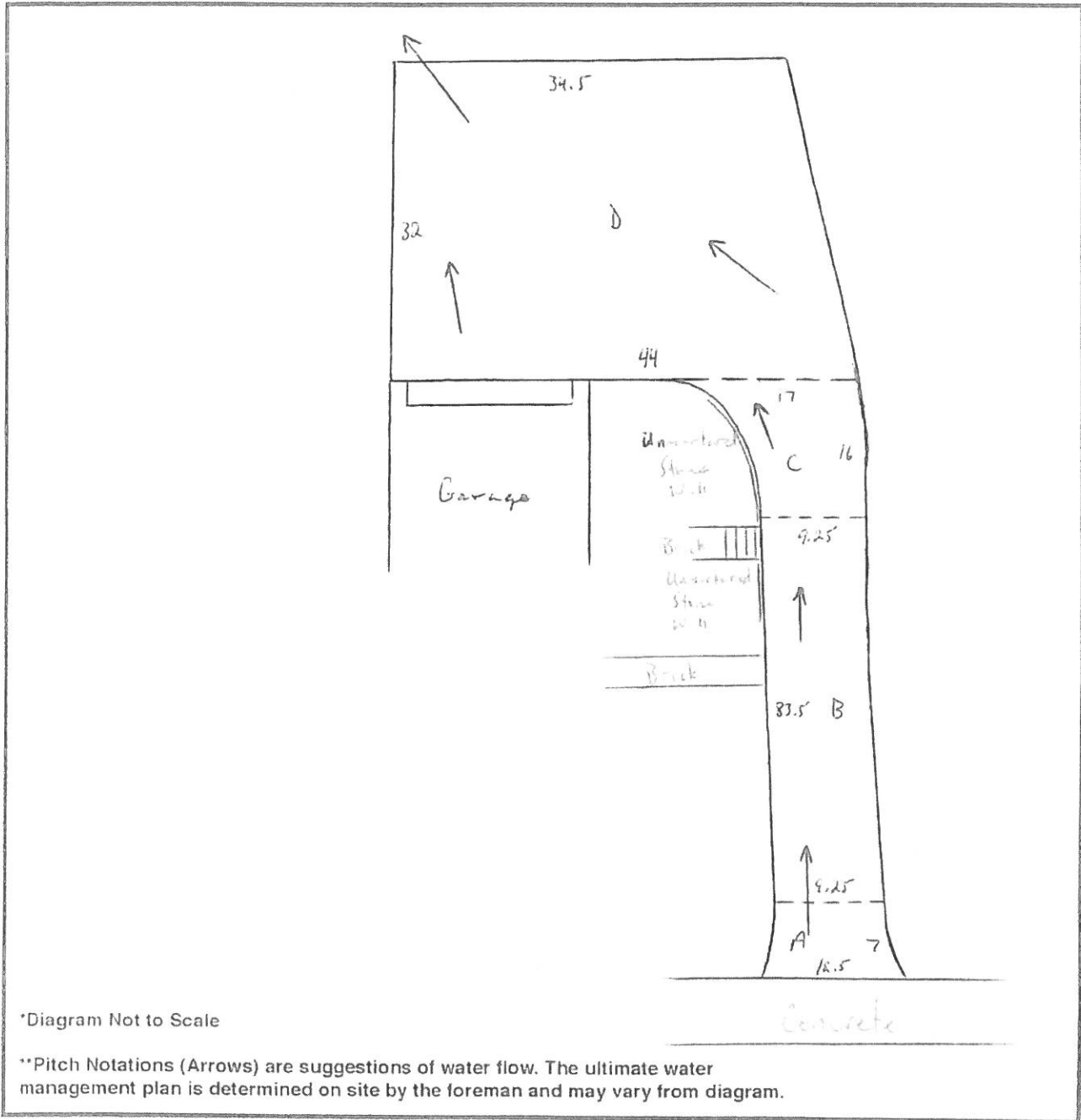

*Diagram Not to Scale

**Pitch Notations (Arrows) are suggestions of water flow. The ultimate water management plan is determined on site by the foreman and may vary from diagram.

Client Signature: _____ Date: _____

Estimate #: _____

8.

Photos

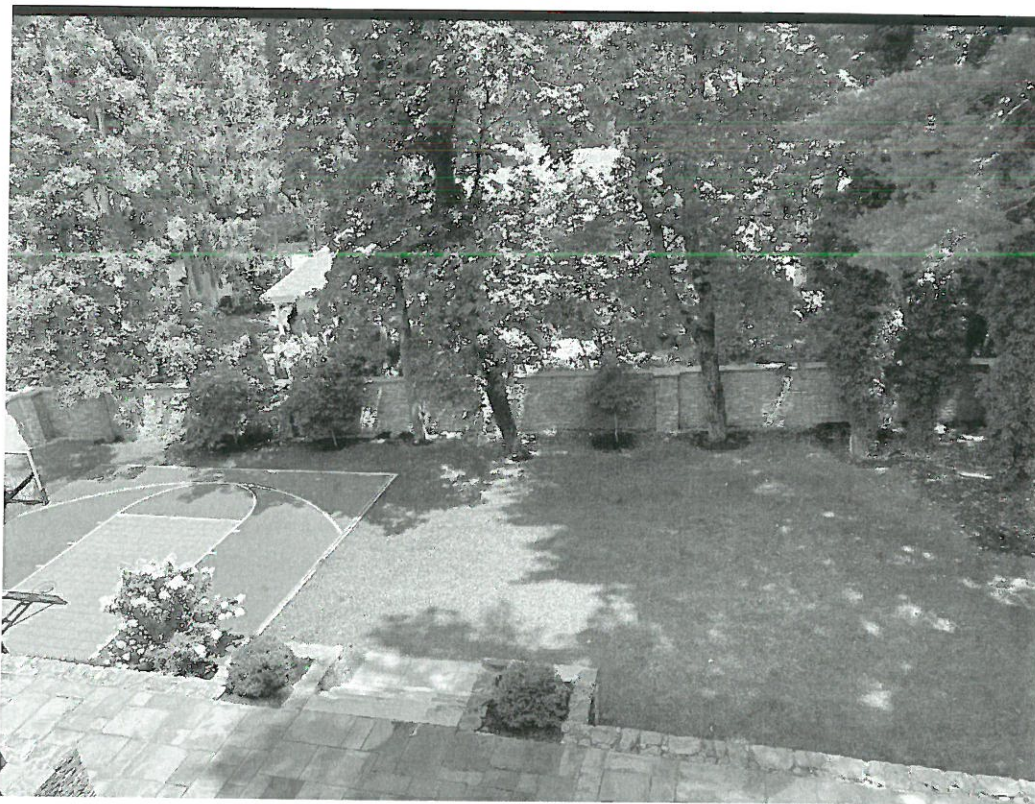



11:24



Right Side



11:25



Garage Side

